

FOR LEASE/SALE

1.49 – 4.81 ACRES OF VEHICLE-ORIENTED OPPORTUNITIES ON ABBOTSFORD AUTOMALL LANDS

30018, 30032, & 30066 AUTOMALL PLACE, ABBOTSFORD, B.C.



Marcus & Millichap

Jack Allpress
Personal Real Estate Corporation
Senior Managing Director Investments
(604) 638-1975
JAllpress@MarcusMillichap.com

Robert Hamilton
Senior Associate
(604) 398-2773
RHamilton@MarcusMillichap.com

OPPORTUNITY

Situated on the Automall lands in Abbotsford, B.C., the Subject Property offers 1.64 - 4.81 acres of automotive-zoned land available for lease or sale.

The Subject Property's Automall Commercial Zone (CAM) zoning designation accommodates automotive, commercial vehicle, and RV dealerships, as well as any other associated uses in an auto-mall format, providing a maximum lot coverage of 50% and a 0.50 FSR.

With exposure to over 70,000 vehicles per day via the Trans-Canada Highway and access via Mt. Lehman Road, the Subject Property is a great opportunity to join alongside notable tenants such as Toyota, Mazda, Ford, Honda, Buick, and GM, to name a few, and establish great market presence in Abbotsford's auto center.





SALIENT DETAILS

Gross Size:	1.64 – 4.81 Acres
Address:	Lot 4 - 30018 Automall Place, Abbotsford, B.C. Lot 5 - 30032 Automall Place, Abbotsford, B.C. Lot 6 - 30066 Automall Place, Abbotsford, B.C.
Access / Egress:	Automall Drive via Mt. Lehman Road
Traffic Counts:	Over 100,785 vehicles per day in immediate area
Timing / Possession:	In Final Stages Building 12-18 months from binding deal thereon.
Zoning:	Automall Commercial Zone (CAM)
Asking Rates/Price:	Please Contact Listing Agent

LOCATION OVERVIEW

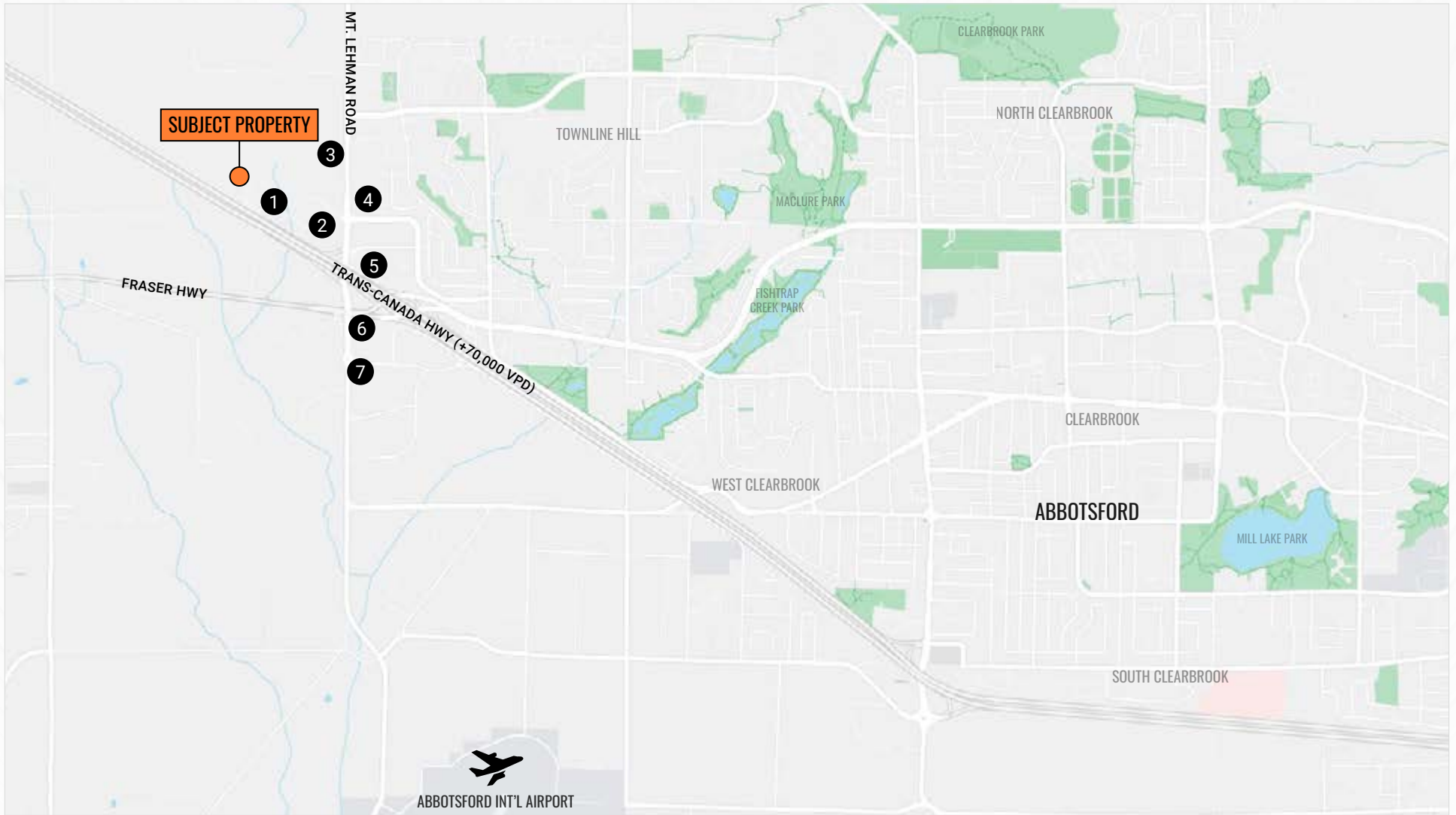

1. Abbotsford Volkswagen, Abbotsford Nissan, OpenRoad Toyota, Abbotsford Chrysler Dodge Jeep Ram, Abbotsford Hyundai
2. MSA Ford Sales, Murray Kia Abbotsford, Tim Hortons, VIP Mazda, The Honda Way, Murray Chevrolet Buick GMC
3. Xchange Business Park by QuadReal Property and Hungerford Properties (140-acres, 1.3M SF)

4. Shell, McDonald's, Quiznos, Starbucks, Dollarama, Co-Op Food Store
5. High Street Shopping Centre: Walmart Supercentre, PetSmart, London Drugs, H&M, Anytime Fitness
6. Travelhome RV
7. Fraserway RV Abbotsford

Demographics	15-Minute Drive	Abbotsford
2022 Total Population	21,861	162,698
Population Growth 2022-2027	8.4%	9.0%
2022 Households	7,044	52,465
Total Daytime Population	24,829	149,605

Marcus & Millichap

MarcusMillichap.com

Jack Allpress
Personal Real Estate Corporation
Senior Managing Director Investments
(604) 638-1975
JAllpress@MarcusMillichap.com

Robert Hamilton
Senior Associate
(604) 398-2773
RHamilton@MarcusMillichap.com

Marcus & Millichap
1100 - 1111 West Georgia Street
Vancouver, BC V6E 4M3
T (604) 638-2121
F (604) 638-2122

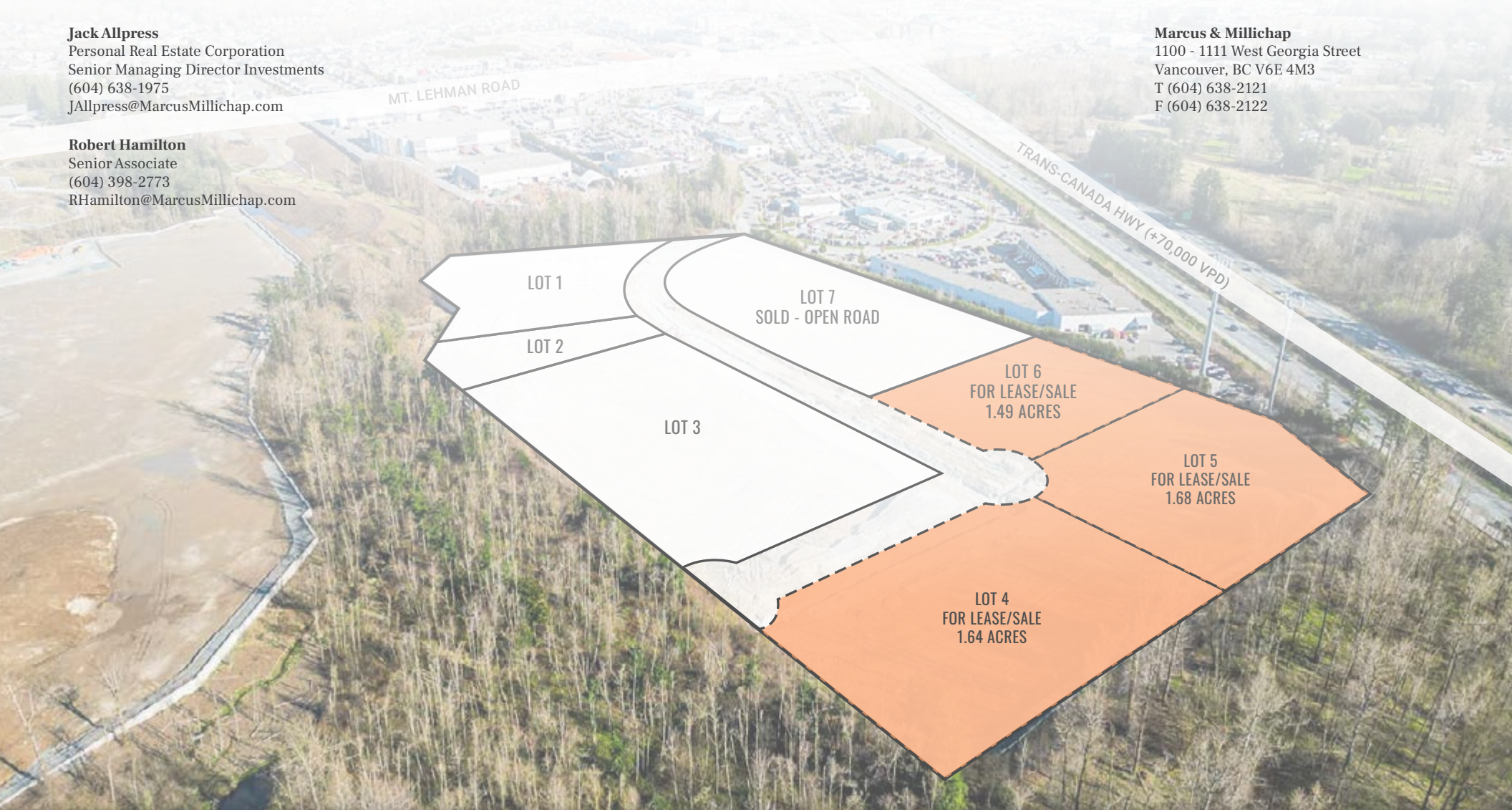

The information contained in the following Marketing Brochure is proprietary and strictly confidential. It is intended to be reviewed only by the party receiving it from Marcus & Millichap and should not be made available to any other person or entity without the written consent of Marcus & Millichap. This Marketing Brochure has been prepared to provide summary, unverified information to prospective purchasers, and to establish only a preliminary level of interest in the subject property. The information contained herein is not a substitute for a thorough due diligence investigation. Marcus & Millichap has not made any investigation, and makes no warranty or representation, with respect to the income or expenses for the subject property, the future projected financial performance of the property, the size and square footage of the property and improvements, the presence or absence of contaminating substances, PCB's or asbestos, the compliance with State and Federal regulations, the physical condition of the improvements thereon, or the financial condition or business prospects of any tenant, or any tenant's plans or intentions to continue its occupancy of the subject property. The information contained in this Marketing Brochure has been obtained from sources we believe to be reliable; however, Marcus & Millichap has not verified, and will not verify, any of the information contained herein, nor has Marcus & Millichap conducted any investigation regarding these matters and makes no warranty or representation whatsoever regarding the accuracy or completeness of the information provided. All potential buyers must take appropriate measures to verify all of the information set forth herein.

Marcus & Millichap is not affiliated with, sponsored by, or endorsed by any commercial tenant or lessee identified in this marketing package. The presence of any corporation's logo or name is not intended to indicate or imply affiliation with, or sponsorship or endorsement by, said corporation of Marcus & Millichap, its affiliates or subsidiaries, or any agent, product, service, or commercial listing of Marcus & Millichap, and is solely included for the purpose of providing tenant lessee information about this listing to prospective customers.

This information has been secured from sources we believe to be reliable, but we make no representations or warranties, express or implied, as to the accuracy of the information. References to square footage or age are approximate. Buyer must verify the information and bears all risk for any inaccuracies. Marcus & Millichap is a trademark of Marcus & Millichap Real Estate Investment Services, Inc. Used under license by Marcus & Millichap Real Estate Investment Services Canada Inc. © 2023 Marcus & Millichap. All rights reserved.