

FOR SALE

Unit # 18 & 19 19257 Enterprise Way  
Surrey, BC



Unit #18	2,450 sf
Unit #19	2,450 sf
<b>Total Contiguous</b>	<b>4,900 sf</b>

**Jordan MacDonald**  
604.640.5883  
jordan.macdonald@ca.cushwake.com

**Kevin Volz**  
604.640.5851  
kevin.volz@ca.cushwake.com



# FOR SALE

## Cambor Business Centre

19257 Units #18 & 19, Enterprise Way, Surrey, BC

### LOCATION

The property is located on Enterprise Way just one block east of 192nd Street. Enterprise Way lies on the fringe of Langley City, and is in close proximity to an array of amenities.

### ZONING

IL (Light Industrial uses)

### BUILDING FEATURES

- 12 year old building
- Concrete block construction
- Front office rear load
- Grade load
- 18' clear ceiling (min)
- 120/208 volt 3-phase power per bay
- Radiant tube heating
- Abundant parking

### AVAILABLE UNITS

Unit #18	2,450 sf
Unit #19	2,450 sf
<b>Total Contiguous</b>	<b>4,900 sf</b>

### UNIT DIMENSIONS

27'x75' per unit

### SALE PRICE

\$340,000 per unit

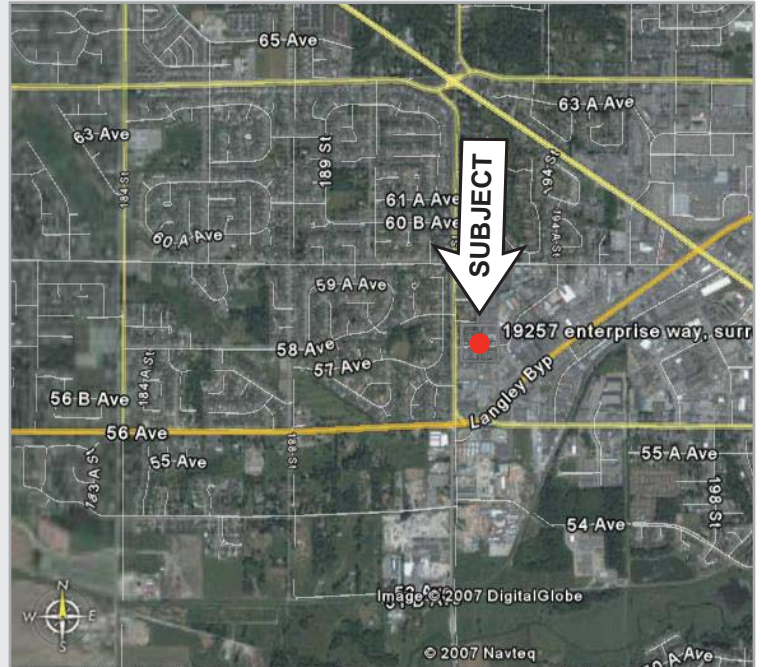

**Jordan MacDonald**

604.640.5883

jordan.macdonald@ca.cushwake.com

**Kevin Volz**

604.640.5851

kevin.volz@ca.cushwake.com

Cushman & Wakefield LePage Inc.  
Suite 700 - 700 West Georgia Street  
P.O. Box 10023, Pacific Centre  
Vancouver, BC V7Y 1A1  
T: 604.683.3111  
F: 604.683.0432  
www.cushmanwakefield.com

